

INSTALLATION

NOTICE:

- Never use SRS parts from another vehicle. When replacing the parts, replace them with new ones.
- Never reuse a seat belt tension sensor involved in a collision when the airbag has deployed.
- If the seat belt tension sensor has been dropped, or there are any cracks, dents or other defects in the case, bracket or connector, replace it with a new one.
- When installing the seat belt tension sensor, be careful that the SRS wiring does not interfere with other parts and that it is not pinched between other parts.
- After installing, shake the seat belt tension sensor to check that there is no looseness.

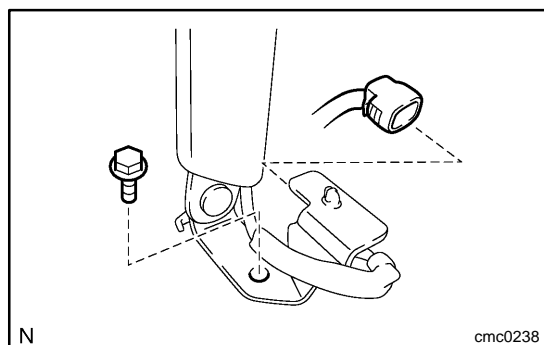

1. **Bench type:**
INSTALL FRONT SEAT OUTER BELT FLOOR ANCHOR RH (SEAT BELT TENSION SENSOR)
 - (a) Install the front seat outer belt RH floor anchor with the bolt.
Torque: 42 N·m (428 kgf-cm, 31 ft-lbf)
 - (b) Connect the connector to the seat belt tension sensor.

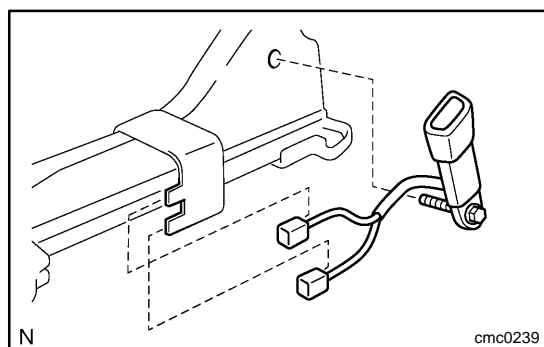

2. **Split type (Passenger's Side):**
INSTALL FRONT SEAT INNER BELT RH (SEAT BELT TENSION SENSOR)
 - (a) Install the front seat inner belt RH (seat belt tension sensor) with the bolt.
Torque: 42 N·m (428 kgf-cm, 31 ft-lbf)
 - (b) Connect the 2 connectors to the front seat inner belt RH.
 - (c) Engage the harness clamps to the seat cushion frame.
3. **Split type (Passenger's Side):**
INSTALL SEAT CUSHION FRAME (SEE PAGE [BO-195](#))
4. **Split type (Passenger's Side):**
INSTALL INNER SEAT TRACK (SEE PAGE [BO-195](#))
5. **Split type (Passenger's Side):**
INSTALL OUTER SEAT TRACK (SEE PAGE [BO-195](#))
6. **Split type (Passenger's Side):**
INSTALL INNER SEAT TRACK LOWER FRONT AND REAR BRACKET (SEE PAGE [BO-195](#))

7. Split type (Passenger's Side):
INSTALL OUTER SEAT TRACK LOWER FRONT AND REAR BRACKET (SEE PAGE [BO-195](#))
8. Split type (Passenger's Side):
INSTALL SEAT HINGE COVER (SEE PAGE [BO-195](#))
9. Split type (Passenger's Side):
INSTALL RH SEAT CUSHION INNER SHIELD AND SEAT CUSHION COVER (SEE PAGE [BO-195](#))
10. Split type (Passenger's Side):
INSTALL RH CENTER SEAT HINGE COVER
(SEE PAGE [BO-195](#))
11. Split type (Passenger's Side):
INSTALL SEAT POSITION SENSOR ASSEMBLY
(SEE PAGE [BO-195](#))
12. Split type (Passenger's Side):
INSTALL SEATBACK ASSEMBLY
(SEE PAGE [BO-195](#))
13. Split type (Passenger's Side):
INSTALL SEAT CUSHION LOWER SHIELD
(SEE PAGE [BO-195](#))
14. Split type (Passenger's Side):
INSTALL RH SEAT CUSHION SHIELD
(SEE PAGE [BO-195](#))
15. Split type (Passenger's Side):
INSTALL RECLINING ADJUSTER RELEASE HANDLE
(SEE PAGE [BO-195](#))
16. Split type (Passenger's Side):
INSTALL SEAT LEG INNER COVER
(SEE PAGE [BO-195](#))
17. Split type (Passenger's Side):
INSTALL FRONT SEAT ASSEMBLY RH
(SEE PAGE [BO-201](#))
18. Split type (Passenger's Side):
INSTALL SEAT TRACK COVER (SEE PAGE [BO-201](#))
19. CONNECT CABLE TO NEGATIVE BATTERY TERMINAL
20. PERFORM ZERO POINT CALIBRATION AND SENSITIVITY CHECK (SEE PAGE [DI-1829](#))
21. INSPECT SRS WARNING LIGHT (SEE PAGE [DI-1839](#))